

5 PARTS LIST

5.1 Basic Parts List

KEY	TP#	ITEM	KEY	TP#	ITEM
	11-1	CONTROL BOX COVER		TP-58B	1/4" PRESSURE TUBE (LOCATED IN FAN OPENING) FOR 8 INCH SWITCH MODELS
	11-2	CONTROL BOX END		TP-58C	1/4" ATMOSPHERIC TUBE (W/VINYL)
	11-4A	CONTROL BOX FOR DTHS	-2-3	TP-57A	1/4" PRESSURE TUBE
	11-5	FLANGE GASKET		TP-57B	1/4" PRESSURE TUBE (LOCATED IN BRNR CHAMBER) FOR SING. SWIT MODEL
	TP-5A	3/8" BURNER TUBE W/ FLANGE (NEW STYLE)		TP-58	MALE COMPRESSION FITTING
	TP-5A	3/8" BURNER TUBE W/ FLANGE - SUB 116A		TP-60	EXHAUST PRESSURE SWITCH
	TP-5C	3/8" BURNER TUBE W/ FLANGE - NO SLOT (125/150)		TP-60A	DWYER # 1011-3 (USED ON 80ME-2)
	TP-9	CONDUIT COUPLING	2	TP-60B	EXHT PRESS. SWITCH - SUB TP-60C
	TP-10	CONDUIT 4" X 1/2"	2	TP-60C	EXHAUST PRESSURE SWITCH
	TP-11	RADIANT SENSOR BOX	3	TP-60D	EXHAUST PRESSURE SWITCH 1
	TP-12	RADIANT SENSOR LID	2	TP-61	BRNR PRESS. SWITCH - DWYER #1911-00
	TP-14	SIGHT GLASS GASKET	2	TP-61A	BURNER PRESS. SWITCH - SUB TP-61B
	TP-15	SIGHT GLASS	3	TP-63	1/4" EXHAUST PRESSURE TUBE
	TP-16	SIG-T GLASS WASHER		TP-64	RADIANT SENSOR
	TP-19A	HANGING CLAMP (USED ON OPT. R)	2-3	TP-65A	66" HEAT DIFFUSER (BAFFLE) CONSULT FACTORY
	TP-19B	4" TUBE & REFLECTOR HANGER	2-3	TP-65B	58" HEAT DIFFUSER (BAFFLE) CONSULT FACTORY
	TP-20B	11" DTH REFLECTOR (USED ON DTHS OPT. B)	2-3	TP-65C	132" HEAT DIFFUSER (BAFFLE) CONSULT FACTORY
	TP-20C	120" DTHS REFLECTOR		TP-66	2" X 4" OUTLET BOX
	TP-21A	TUBE CLAMP - 10-9CA (OLD STYLE)		TP-67	2" X 4" OUTLET BOX COVER
	TP-21B	TUBE CLAMP		TP-68	CONDUIT NIPLLE
	TP-22	REFLECTOR CLAMP (USED ON OPT. B)		TP-68A	STRAIN RELIEF BUSHING
	TP-26	10" RADIANT TUBE STRT. - SUB TP-26A		TP-70	CONTROL BOX COVER GASKET (**PER FOOT)
	TP-26A	10 FT. RADIANT TUBE STRAIGHT		TP-71	RADIANT SENSOR MICA
	TP-26B	10" RAD. TUBE STRT. (AL-TI) (100, 125, 150)		TP-72A	DOOR SWITCH
	TP-27B	CONTROL BOX BRACKET		TP-75	WASHER W/ SHOU DER
	TP-30	RV471-3.8 NAT GAS REGULATOR		TP-76	RUBBER GROMMET
	TP-33P	REPLACES RV35M		TP-77	DICOD BOARD 5001A-1-NLA CONS. FAC.
	TP-33A	RV471-11 PROPANE GAS REGULATOR	2	TP-78A	MOLEX CONNECTOR W/WIRES (125/150)
	TP-33B	REPLACES R400	3	TP-79	VALVE V444A-1028-SUB 38E38A-238
	TP-38C	1/2" GAS COCK	3	TP-79A	VALVE V445A-1199-SUB 11-107P
	TP-34	RV491 NAT GAS REGULATOR SET 4.5 (125/150)	3	TP-82	REFLECTOR CENTER SUPPORT
	TP-35	3/8" X 1/2" BUSHING	3	TP-87	REFLECTOR CENTER SUPPORT
	TP-35	PIPE NIPLLE 3/8" X 2-1/2"	3	TP-100	3/8" ADAPTOR FITTING
	TP-35A	PIPE NIPLLE 1/2" X 4" (125/150)	3	TP-101	3/16" NUT
	TP-36	3/8" GAS VALVE - WR 25K30A-8	3	TP-102	3/8" X 1-1/2" PIPE NIPLLE
	TP-36A	VALVE 36C88A-241 - NLA- CONSULT FAC.	2	TP-103	1/2" X 2" PIPE NIPLLE
	TP-36B	VALVE 36C88A-241 - NLA- CONSULT FAC.	3	TP-104	REFLECTOR END CAP
	TP-36C	VALVE 36C88A-241 - NLA- CONSULT FAC.	3	TP-105	REFLECTOR CLIP
	TP-37	3/8" UNION FITTING - SUB TP-100 & TP-102	2	TP-107	38E38A-231 GAS VALVE (125/150)
	TP-37A	1/2" UNION FITTING (125, 150) SUB TP-100	3	TP-107P	SUB 30E30A-240
	TP-38	UNION NUT - SUB TP-100, TP-101, & TP-102	3	TP-108	38E38A-240 GAS VALVE LP GAS (125, 150PI)
	TP-39	1" X 1/2" UNION BUSHING - SUB 11-101	3	TP-109	5 AL-TI USE, PAINTED, DBL SWEDGE 2 CLAMPS
	TP-40	1/2" X 1/4" BUSHING - SUB TP-100, TP-102	3	TP-111	5 ALUM. TUBE, PAINTED W/ CLAMP
	TP-42	BURNER CASTING W/ ORIFICE BRACKET	3	TP-112	5 REFLECTOR
	TP-44	AIR ORIFICE W/ SCREEN - CONSULT FAC.	3	TP-122	GASKET FOR AIR DRIEFT & AIR COLLAR
	TP-45	1/4" X 1/8" BUSHING - SUB TP-100, TP-102	3	TP-CPA-2	CENTER PANEL ASSEMBLY - 2 MODELS
	TP-46	BURNER ORIFICE - CONSULT FACTORY	3	TP-CPA-3	CENTER PANEL ASSEMBLY - 3 MODELS
	TP-49	MAIN BURNER	3	KEY:	
	TP-50	GLO-BAR IGNITOR	3	11" = PART FOR NEW STYLE SWEDGED TUBES	
	TP-51	1/4" EXHAUST PRESSURE TUBE	3	1-2" = PART FOR 2 MODEL UNITS	
	TP-54	BURNER BOX DIMSER	3	1-3" = PART FOR 3 MODEL UNITS	
	TP-55	FAN BLOWER	3	ORDER \$ PER BURNER BOX TO COVER OUTER EDGES	
	TP-55A	FAN BLOWER	3		
	TP-56A	1/4" BURNER PRESSURE TUBE	3		

PARTS WITHOUT SYMBOLS ARE COMMON TO ALL DTHS HEATERS
 NOTE: IN ORDER TO PLACE ORDERS CORRECTLY, YOU MUST REFER TO THE KEY AREA OF THIS LIST.
 ORDERS MUST BE PLACED USING THE APPROPRIATE TP# STOCK NUMBER.
 11-C1A - GET BURNER, EXHT & BRNR PRESS. SW T. BLOWER AND FITTINGS

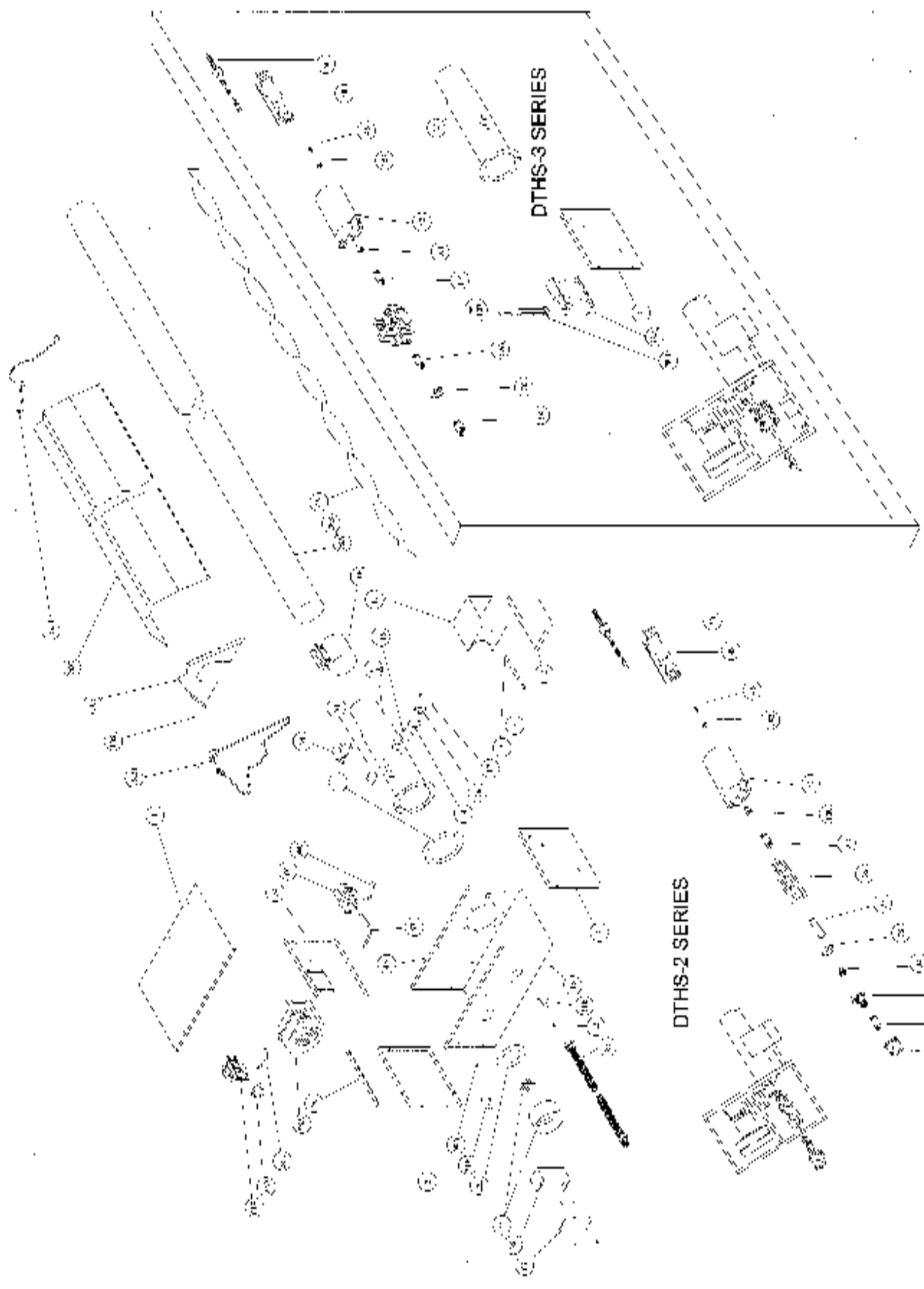

W-932047784LES0-1P-9-PC-1118400N-1000P001-1-0211073-DTHS2-4-001-001-001-001